

# InterSole SE

In-roof system

Installation Guide



1 Place extra battens and attach a sealing strip



2 Hook the first row of Intersole plates or rolls



3 Mount the optional gutter LOWER



4 Position and screw the anchors



5 Fix the other InterSole plates/rolls with anchors



6 Position an optional anchor



7 Mount the side gutter

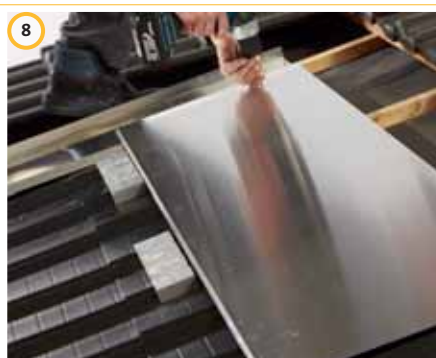

8 Mount the gutter UPPER



9 Place the sealing tape



10 Install the mounting rail with brackets



11 Adjust end and middle clamps to the PV module frame and fix them



12 Mount the PV modules



13 Adjust top and side tiles



14 **InterSole SE**